

Sanitary Self-Priming Pump

JS



Application

New Revolutionary Technology
JS is appropriate for application requiring a hygienic requirement, gentle handling of product and resistance chemical agent.
It is suitable as process pump in dairy, beverage, pharmaceutical, cosmetic and other chemical industry.

Design

These self-priming pumps combine JC impellers with a screw rotor and recirculation loop to generate liquid ring and produce a vacuum.
it handle entrained air, gaseous liquid and lift

First Operation

Pump casing, tube should be flooded and maintain min. volume as required.
Lower speed reduce suction ability

Features and Benefits

Idea for CIP Return	handle gas liquid fluid
Clean Design	meet sanitary requirement
High Efficiency	higher than other self-priming pump
Parts interchangeability	parts interchange with JC
Low Noise Level	Compare to liquid ring pump 40% less
Particle Passage	non-clog open impeller

Option

Re-circulating tube	316L
Connection	DIN11851, IDF, SMS
O-Ring	FKM, NBR, Silicone, FFKM
Mechanical Seal	double flushing other material upon request

Casing Drain
Exp-motor

Technical Specification (Standard)

Materials

Product contact parts:	AISI 316L
Other steel	AISI 304
O-Ring in contact with product	EPDM

Mechanic External Seal Single

Rotating part	Carbon / EPDM
Stationary part	Silicone Carbide / Teflon

Connection Tri-Clamp (Standard)

Surface Finish

External	Matt
Internal	Ra<0.5 Ra, except rotor (Standard : Sand Blast)

Operating Limits

Max. Temperature	120°C
Max. Flow	50 m ³ /hr
Max. Discharge Pressure	66 M
Max. Speed	3600 rpm

Sanitary Self-Priming Pump

JS

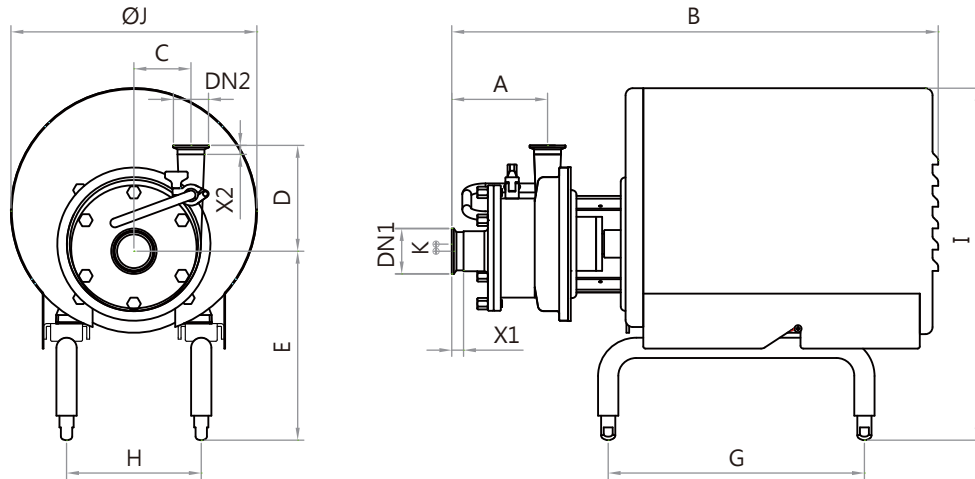

Dimensions X₁, X₂

	DIN 11851		SMS		CLAMP		IDF			
	DN ₁	DN ₂	X ₁	X ₂	X ₁	X ₂	X ₁	X ₂		
40-140	2"	1.5"	32	32	23	23	12.7	12.7	21.5	21.5
40-170	2"	1.5"	35	32	23	23	12.7	12.7	21.5	21.5
40-170W	2"	1.5"	35	32	23	23	12.7	12.7	21.5	21.5

Dimensions

	kW	Motor	DN ₁	DN ₂	A	B	C	D	E	G	H	I	ØJ	K	Kg
JS 40-140	1.5	90	2"	1.5"	144	619	72	125	235±9	298	140	438±9	Ø296	8	33
	2.2	90	2"	1.5"	144	619	72	125	235±9	298	140	438±9	Ø296	8	36
	3	100	2"	1.5"	144	692	72	125	257±9	390	190	487±9	Ø347	8	46
	4	112	2"	1.5"	144	692	72	125	257±9	390	190	487±9	Ø347	8	56
JS 40-170	4	112	2"	1.5"	145	703	80	149	257±9	390	190	487±9	Ø347	10	52
	5.5	132	2"	1.5"	145	833	80	149	277±9	390	216	507±9	Ø347	10	58
	7.5	132	2"	1.5"	145	833	80	149	277±9	390	216	507±9	Ø347	10	77
	11	160	2"	1.5"	145	833	80	149	277±9	390	216	507±9	Ø347	10	91
JS 40-170W	4	112	2"	1.5"	145	703	112	154	257±9	390	190	487±9	Ø347	10	53
	5.5	132	2"	1.5"	145	833	112	154	277±9	390	216	507±9	Ø347	10	59
	7.5	132	2"	1.5"	145	833	112	154	277±9	390	216	507±9	Ø347	10	77
	11	132	2"	1.5"	145	833	80	154	277±9	390	216	507±9	Ø347	10	92